

RS SYSTEM SERVICE PROCEDURE

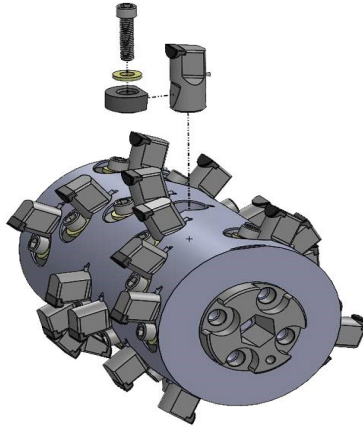

CAUTION: Wear safety glasses, close-toed shoes, and other protective clothing at all times while performing service to drum.

1. Remove the socket head cap screw from the wedge. The SHCS takes a 5/16 Allen wrench.
2. Thread the slide hammer shoulder bolt into the wedge. The Wedge is tapped with a 1/2-13 UNC thread.
3. Use slide hammer to pull the wedge and bit out of the pocket.
4. Clean bit holder pocket extensively.
5. Apply anti-seize to sides of pocket and angled face of new bit. Place new bit and wedge into the pocket with anti-seize. Make sure the bit is aligned straight with alignment pin.
6. Insert socket head cap screw and tighten bolt to 35 foot pounds.
7. After three hours of use, retighten bolts to 35 foot pounds.



*Keystone offers a wide variety of PCD tooling options. Please call 317-271-6192 for more information or visit www.keystonecutter.com

WARNING: Never adjust or work on the drum while the power unit or attachment is running or the key is in the ignition or serious injury or death could result. Before making any adjustments or performing any service to the grinding drum; engage the parking brake, turn off engine and remove the ignition key.